

Installation guide – Spare parts and accessories

Overhaul kit | Code number 027F3379
PM, size 125 - standard cone

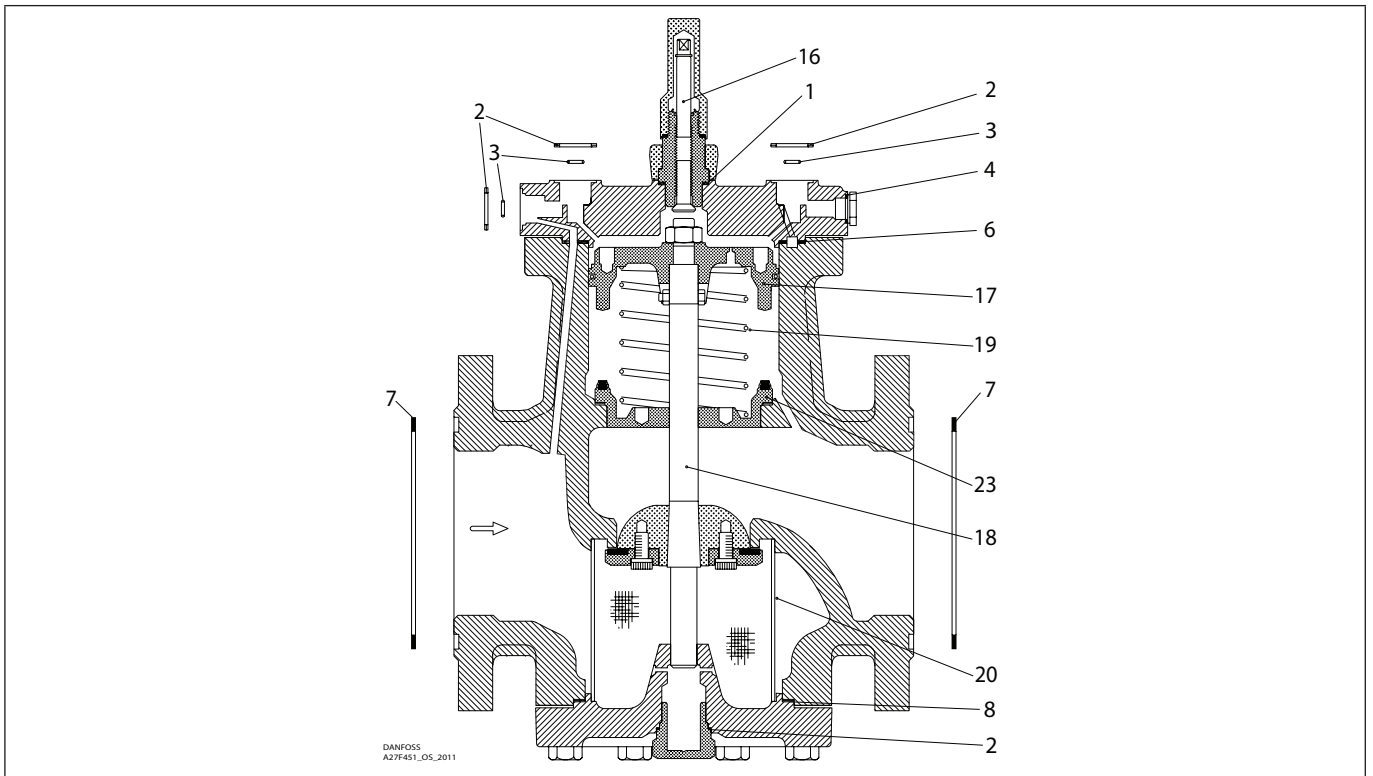

<p>1**</p> <p> = Fibre</p> <p>Total no. = 1</p>	<p>2</p> <p> = Fibre</p> <p>Total no. = 4</p>	<p>3</p> <p> = Al.</p> <p>Total no. = 3</p>	<p>4</p> <p> = Al.</p> <p>Total no. = 1</p>	<p>5*</p> <p> = Al.</p> <p>Total no. = 1</p>	<p>6</p> <p> = Fibre</p> <p>Total no. = 1</p>
<p>7</p> <p> = Fibre</p> <p>Total no. = 2</p>	<p>8</p> <p> = Fibre</p> <p>Total no. = 1</p>	<p>9*</p> <p> = Al.</p> <p>Total no. = 1</p>	<p>10*</p> <p> = Al.</p> <p>Total no. = 1</p>	<p>16</p>	<p>17</p>
<p>18</p>	<p>19</p> <p>Total no. = 1</p>	<p>20</p> <p>Total no. = 1</p>	<p>23</p>		

* The spare part is included in the package but is not used for PM size 125 with standard cone.

** Included in manual opening device.